

Peg Version

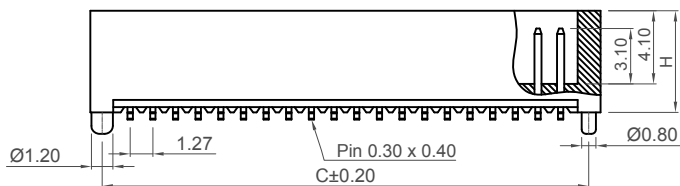

Key Lock Version

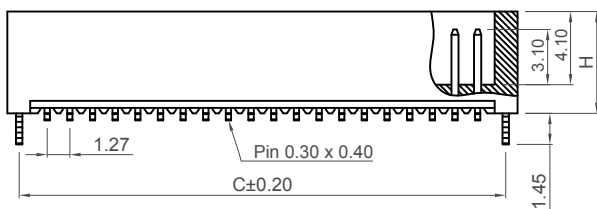

NOTE: Views above show 5.70mm insulator 'H' height version with protruding SMT leads, SMT leads on 7.30mm version are flush with insulator, and measure 0.40mm sq. Contact GCT for more information.

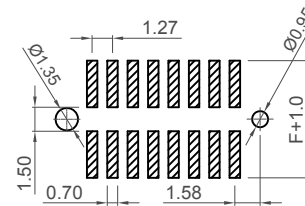
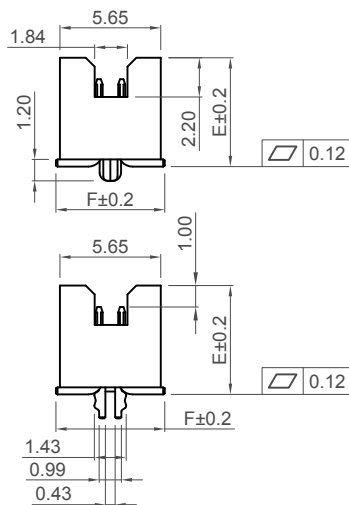

Recommended PCB Layout

(Locating Peg option)

☒ Solder Area

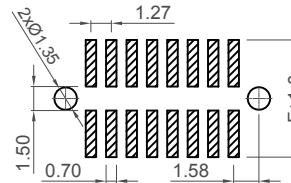

Recommended PCB Layout

(Key Lock option)

☒ Solder Area

No. of Contacts	Dimensions			
	A	B	C	D
10	5.08	9.55	8.23	6.95
12	6.35	10.82	9.50	8.22
14	7.62	12.09	10.77	9.49
16	8.89	13.36	12.04	10.76
18	10.16	14.63	13.31	12.03
20	11.43	15.90	14.58	13.30
22	12.70	17.17	15.85	14.57
24	13.97	18.44	17.12	15.84
26	15.24	19.71	18.39	17.11
28	16.51	20.98	19.66	18.38
30	17.78	22.25	20.93	19.65
32	19.05	23.52	22.20	20.92
34	20.32	24.79	23.47	22.19
36	21.59	26.06	24.74	23.46
38	22.86	27.33	26.01	24.73
40	24.13	28.60	27.28	26.00
42	25.40	29.87	28.55	27.27
44	26.67	31.14	29.82	28.54
46	27.94	32.41	31.09	29.81
48	29.21	33.68	32.36	31.08
50	30.48	34.95	33.63	32.35
52	31.75	36.22	34.90	33.62
54	33.02	37.49	36.17	34.89
56	34.29	38.76	37.44	36.16
58	35.56	40.03	38.71	37.43
60	36.83	41.30	39.98	38.70
62	38.10	42.57	41.25	39.97
64	39.37	43.84	42.52	41.24
66	40.64	45.11	43.79	42.51
68	41.91	46.38	45.06	43.78
70	43.18	47.65	46.33	45.05
72	44.45	48.92	47.60	46.32
74	45.72	50.19	48.87	47.59
76	46.99	51.46	50.14	48.86
78	48.26	52.73	51.41	50.13
80	49.53	54.00	52.68	51.40
82	50.80	55.27	53.95	52.67
84	52.07	56.54	55.22	53.94
86	53.34	57.81	56.49	55.21
88	54.61	59.08	57.76	56.48
90	55.88	60.35	59.03	57.75
92	57.15	61.62	60.30	59.02
94	58.42	62.89	61.57	60.29
96	59.69	64.16	62.84	61.56
98	60.96	65.43	64.11	62.83
100	62.23	66.70	65.38	64.10

Specifications

Material

Insulator Material: Polymer, LCP, UL 94V-0
 Contact Terminal: Copper Alloy

Plating

See Ordering Grid

Electrical

Current Rating: 1A per pin
 Contact Resistance: 20 mΩ max.
 Insulating Resistance: 1000 MΩ min.
 Dielectric Withstand Voltage: 300V AC

Soldering Process:

IR Reflow: 260°C for 10 sec.
 Wave: 250°C for 5-10 sec
 Manual Solder: 350°C for 3-5 sec

Mechanical & Environmental

Operating Temperature: -40°C to +105°C

Mates with (Subject to pin length)

BD065 - Allowing perfect polarisation
 Non-Polarised mating connections available
 contact GCT for details

Ordering Grid

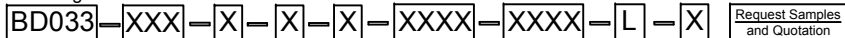

No. of Contacts
 10 to 100
 e.g. 10 = 010

Contact Plating

A = Gold Flash All Over (Standard)
 B = Selective Gold Flash Contact Area/
 Tin On Tail
 C = Tin All Over
 G = 10µ" Gold Contact Area/Tin On Tail
 I = 30µ" Gold Contact Area/Tin On Tail

Insulator

Height 'H'
 S = 5.70mm (Standard)
 T = 7.30mm

Locating Peg

0 = No Peg/No key Lock
 1 = With Peg
 2 = With Key Lock

Dimension E (1/100mm)

(Top of Insulator to Bottom of Pin)
 0610 = 6.10mm (Standard = Max=Min=6.10mm when 'H' = 5.70mm)
 0730 = 7.30mm (Standard = Min=7.30mm, Max=7.50mm when 'H' = 7.30mm)
 or specify Dimension E
 eg 0250 = 2.50mm

Packing Options

D = Tube (Standard)
 B = Tape & Reel with Cap
 E = Tube with Cap

Insulator Material

L = LCP

Dimension F (1/100mm)
(Footprint Width)

0630 = 6.30mm (Standard)
 or specify custom Dimension F
 (Tooling charge may apply)

Part Number		Product Description	
BD033		1.27mm Pitch Shrouded Pin Header	
Drawing Date		Dual Row, Surface Mount, Vertical	
3rd April 2008			
By	CC	Tolerances (Except as Noted)	Units:
Detail	BD033 F PCN	Length X. ± 0.30 X.X ± 0.25 X.XX ± 0.15 X.XXX ± 0.10	Metric (mm)
Revision	F3	Angle X.° ± 5° X.XX° ± 3° X.XXX° ± 2° X.XXX° ± 1°	3rd Angle Projection
Date	11/04/19		



This drawing is confidential and copyright of Global Connector Technology, Ltd (GCT). This drawing must not be copied or disclosed without written consent. E & OE



www.gct.co

Not to Scale	Drawn By ASE	Sheet No. 1/1
--------------	--------------	---------------

H
G
F
E
D
C
B
A